

VENUE INFORMATION & TECHNICAL SPECIFICATION 2025

55 Weston Street
London
SE1 3RA

Web: www.kcl.ac.uk/greenwood

Email: greenwood@kcl.ac.uk

Telephone: 0207 848 8629

Table of Contents

Contact details	3
Seating capacity	4
Access and loading	4
Parking and loading	5
Staffing	6
Stage information and dimensions	6
Stage equipment and masking	7
Flying	8
On stage fly bar plan	9
Orchestra pit	10
Stage management	10
Control room	11
Power	11
Dressing rooms	12
Lighting	13
Sound	15
Projection equipment	16
Plans	16
Circuit plan	17
Seating plan	18
Standard rig	19
Section plan	20
Stage detail (not to be scaled)	21
Auditorium detail (not to be scaled)	22
Show pictures	23

Disclaimer

We cannot guarantee that ALL equipment listed in the specification is available and working. Please check with us if there is anything critical (for example, if all units of a particular lantern are required) and checks can be made on their status.

Whilst we try our utmost to keep this specification as up-to-date as possible, it is subject to change without prior notice.

We reserve the right to refuse the installation or use of equipment which we feel is electrically unsafe, mechanically unsound or incorrectly rated for the application.

Contact Details

All enquiries regarding venue hire, availability and rates should be initially directed to King's Venues:

- www.kingsvenues.com

All other enquiries including technical aspects should be directed to the theatre manager, Simon Taylor:

- simon.taylor@kcl.ac.uk
- 020 7848 8629

The address for the theatre is:

Greenwood Theatre
55 Weston Street
London
SE1 3RA

greenwood@kcl.ac.uk
0207 848 8629

what3words location: [///drove.ideas.party](https://www.what3words.com/drove.ideas.party)



/GreenwoodTheatre



/GWTheatre



/GreenwoodTheatre

Seating Capacity

Total seated: **450**

Total standing: **0**

Usher requirement: **4** (please subtract from capacity)

Wheelchair spaces: **2-4** (along front row)

Our sound desk is located in line with the back row of seating. The back row is considered a fire exit, and as such all cables must pass at floor level where they must be taped down, or pass overhead.

Access and Loading

The Greenwood Theatre has a loading bay, however due to site geometry and removal of access roads, it is strongly advisable to arrange a site visit and inspect the space yourself.

The loading bay / scene dock floor is approximately 0.6m above ground level.

Level access, double doors and large foyer space does allow for set and equipment to be moved though the rear door and loaded onto the orchestra pit which is then raised to stage level. A small lift (SWL 650kg) is available to gain access to the upper foyer, which provides level access to the back row of the auditorium. Control room access is up an additional 5 steps.

Level access is available to the ground floor dressing rooms if required by means of a rear fire exit. Please note that this exit is alarmed, and you will need to advise the duty manager if you require access to this door.

Please note there is currently no step-free access to the stage.

Please feel free to call and discuss arrangements if needed.

Parking

The theatre has parking for one van or small HGV, this facility may only be used with prior agreement from theatre staff and only during your get-in, show and get-out. No overnight parking is possible. Fire exits must always be kept clear.

On street parking arrangements are as shown in the diagram below. Parking bays can be suspended on request, please contact Southwark Council parking services on 0800 138 9081 for charges and more information if required. The red hatched area below shows our loading bay, which is accessed by following signs to Guy's Hospital Deliveries.

Please note, there is no on-site parking for cast or audience members, however there is a large NCP car park less than two minutes walk on Kipling Street.

<https://www.ncp.co.uk/find-a-car-park/car-parks/london-bridge/>

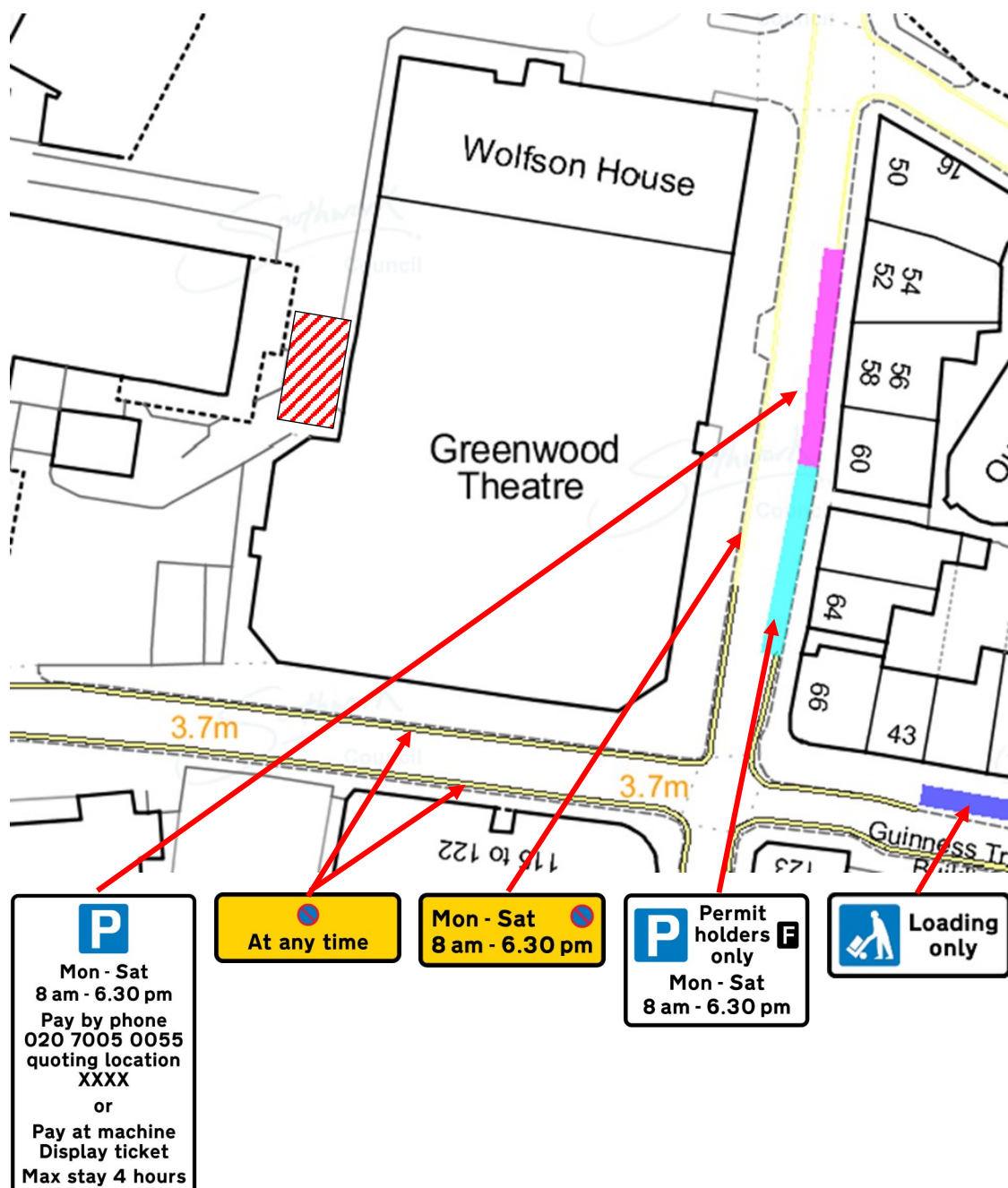

Staffing

All hires include a Duty Manager. This person must be on-site whenever anyone from the production company is working. The Duty Managers job is to oversee the health and safety of all persons in the building, including the production team, and audience members. They also ensure the proper use of the space and in-house equipment. They are able assist with the lighting and sound rig so long as this doesn't prevent them from overseeing the aforementioned supervision. There will be times when they are performing venue maintenance and administrative tasks, so please do not expect on them to be a reliable part of your production team.

Where required, additional members of tech staff can be supplied to assist with setup and/or operate sound, lighting etc, subject to availability.

In-house creatives and additional crew are available from time to time, please check with King's Venues for rates and availability. We encourage you to source your own production crew where possible as they will already have a knowledge of your show and its intricacies.

We also provide 4 ushers for performances who act as fire evacuation marshals plus a security guard manning the front door.

Stage Information and Dimensions

The stage is finished in a black Harlequin Standfast dance, performance and stage floor. It is not permitted to paint, drill or screw anything into this floor. The wings are covered with unfinished plywood.

The maximum floor loading on the main stage is 68kg/ft²

Please see below for approximate dimensions. Whilst some PDF CAD plans are available on request, **we strongly encourage clients to measure the space themselves** to ensure that any set will fit.

- | | | |
|---|---|--------|
| • Width of Harlequin floor | - | 15m |
| • Width of stage including wings | - | 19m |
| • Width of proscenium arch | - | 10.97m |
| • Width of orchestra pit at downstage edge | - | 11.4m |
| • Width of orchestra pit at upstage edge | - | 8.9m |
| • Width of on stage fly bars (longest bars) | - | 13.4m |
| • Width of scene dock and stage shutter | - | 2.1m |
| | | |
| • Height of proscenium arch | - | 5m |
| • Height of grid above stage level | - | 13.8m |
| • Height of cyclorama rail | - | 6.4m |
| • Height of stage from auditorium level | - | 0.6m |
| | | |
| • Drop of lowered orchestra pit from stage | - | 2.6m |
| • Drop of lowered orchestra pit from auditorium | - | 2m |
| | | |
| • Depth of orchestra pit | - | 2.6m |
| • Depth of stage from downstage edge of pit to cyclorama rail | - | 10m |

Stage Equipment and Masking

- Aluminium Access Products Tallescope model 50512
- Various A-frame stepladders

- 2x black wool serge leg - 6.0m drop, 2.9m width
- 2x black wool serge leg - 6.7m drop, 3.7m width
- 1x black wool serge leg - 5.9m drop, 1.2m width
- 6x black wool serge ½ stage leg - 6.4m drop, 6.9m width
- 1x black wool serge ½ stage leg - 6.0m drop, 5.8m width
- 3x black wool serge border - 6.0m drop 12.0m width
- 1x black wool serge full stage cloth - 6.0m drop, 11.5m width
- 1x black wool serge full stage cloth
- 1x white cyclorama (installed on cyc rail) - 6.4m drop, 19.0m width

- 6x ProLyte StageDex 1m x 2m deck
- 24x 300 - 450mm legs for decking
- 24x 450 - 900mm legs for decking
- 8x 300mm fixed legs for decking
- 2x ProLyte StageDex stair unit
- Hand rails for stairs
- Railings for decking

Additionally 5x hard masking flats per side are currently tied to the grid. This allows for a wider stage as the flats can be angled.

A selection of sandbags, stage weights, counterweights, stage braces, conduit, scaffold tube, tank traps and tripod and nipper stands are available for use.

Flying

The Greenwood Theatre has a mix of both single purchase counterweight bars behind the proscenium arch, and motorised bars in front of the proscenium arch. The 30 counterweight bars are 48mm diameter and most are approximately 13.4m long. To accommodate the curved cyclorama rails, they are shorter towards the rear of the stage. The maximum load is 300kg (uniformly distributed). The bars are operated from the fly floor on stage right. 4 bars are fitted with IWBs. 2 additional bars (making a total of 32) run parallel with the wings (1x SL, 1x SR). These bars are not often used and cannot be fully utilised as the cyclorama rail obstructs their path. The most upstage bar is limited to approximately 6.4m travel from deck to upper dead as the cyclorama rail supports obstructs its path.

We do not require any members of the fly crew to have any experience, as we provide a short safety demonstration / training session. A similar session is given to experienced fly crew to demonstrate the location and means emergency exits as well as local safety policies. Only experienced fly crew are permitted to adjust weights on bars, this will be assessed by the duty manager. Access to the fly floor is only permitted to persons either being trained, or who have had training. Fly crew do not need to be of any particular build or stature, but they should be able to lift approximately 20kg. A pair of gloves is recommended, but not required.

The motorised bars in front of the proscenium arch and above row B of auditorium are 48mm diameter IWBs designed for lighting use only, they must be operated by line of sight only and not moved during shows. The maximum load is 250kg (uniformly distributed). There are 3x Stagemaster SR2 hoists per bar. The control panel is located downstage stage left and is equipped with a 10m wired remote control.

The motorised bars above the middle and rear of the auditorium are 2inch diameter. The bars above the middle of the auditorium are currently fitted with 4 way 48mm diameter IWBs per bar. The bars above the rear of the auditorium are not fitted with any IWBs however there are dimmer outlets located adjacent to the hoist motor in the ceiling area. There is one Hall Stage Equipment pilewind hoist per bar. The control panel is located downstage left with a 20m wired remote control.

The cyclorama rails comprise of two tracks and has a lift out section for the downstage rail, downstage right, above the prompt desk. This is used to store the in-house cyc when not in use. This lift can also lower the rail to stage level for rigging or maintenance. A set of points is available upstage right to switch rails.

The safety curtain, drencher, lantern release and orchestra pit lift is operated from the prompt desk on stage right.

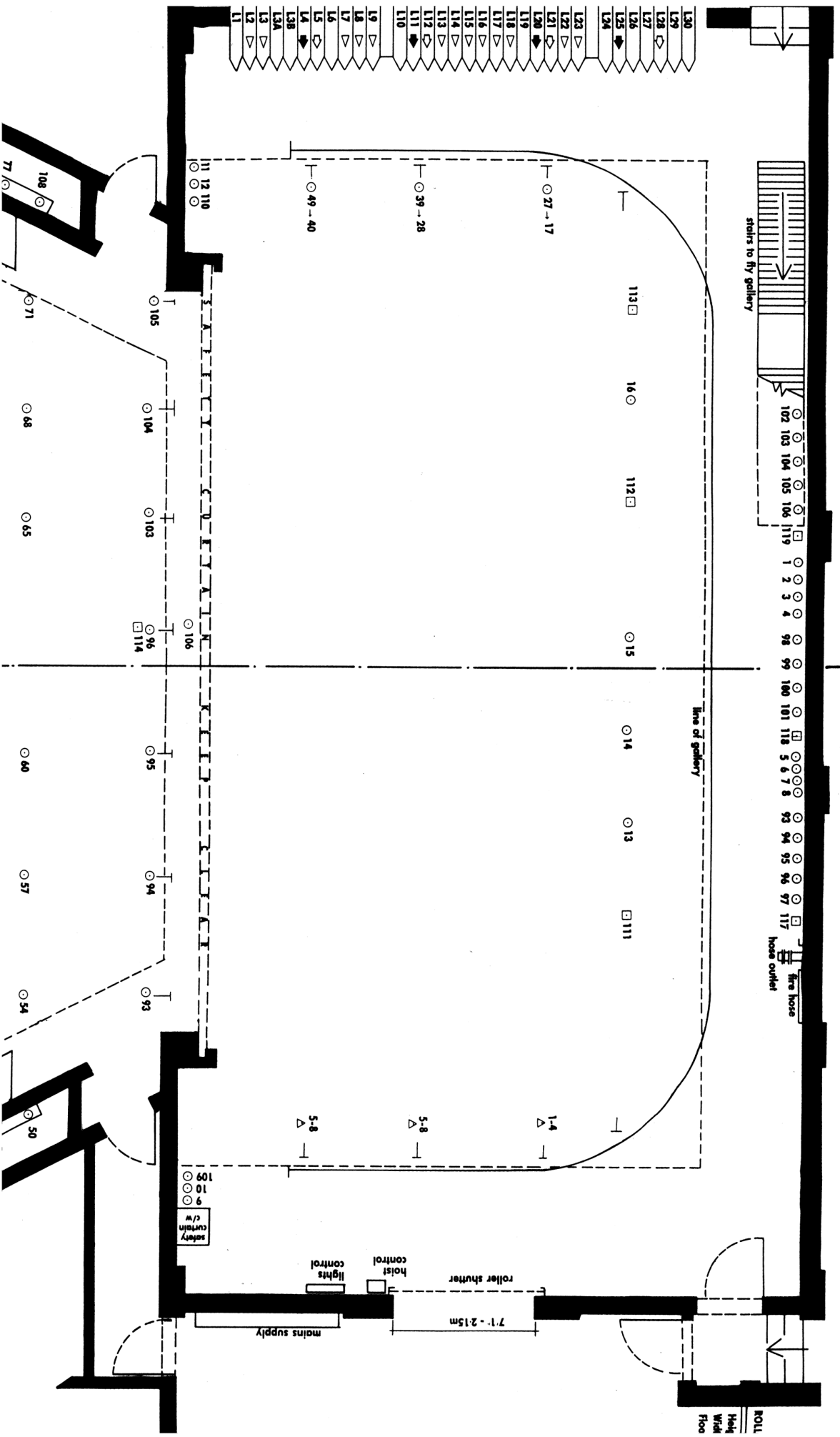

Orchestra Pit

The orchestra pit lift has a SWL of 2000kg (uniformly distributed). When lowered a door is revealed into the under stage corridor, access is then available to backstage. Mains power sockets are available in each of the three floor boxes in the pit, a comms outlet is provided in the centre stage floor box. Other XLR and fibre connections are provided in the floor box connected to a 'lecture theatre AV system'. Please note that any other cables must be lowered into the pit from stage or auditorium level.

If your booking doesn't include the hours from 8am - 5pm it is possible that the theatre may be used by the University for teaching during term time. If the venue is used for this, the orchestra pit must be raised each night and cleared. An AV lectern will be wheeled into place just upstage of the SR floor box for teaching.

Whenever the pit is below auditorium level, railings (provided in-house) must be installed to protect the audience. Where possible, it is advisable to place a 40' (12.2m) border over the railings to provide an improved look and increased acoustic performance. A white tape line must also be placed on the new edge of stage whenever the pit is below stage level.

Stage Management

The Greenwood Theatre has an opposite (bastard) prompt corner, that is to say it is located downstage right.

It has access to the backstage tannoy system/microphone with chime for dressing room calls.

A screen is provided to allow the stage manager to view a camera feed of the stage, which includes night vision for blackouts.

The stage manager also has access to on stage and auditorium working light and 'show blues' lighting controls.

Communications is done by way of TecPro BP111 beltpack and single earpiece headsets. All comms are on a single channel. Outlets for comms are in each corner of the stage, fly floor, orchestra pit, sound desk, lighting desk, AV desk and followspot.

Control Room

The control room is located at the rear of the auditorium and houses lighting control and projection equipment, it is also the followspot position.

At the back of the room is a comfortable sofa, tables as well as the FOH announcement system (dedicated PC, mixer and amplifiers) AV control and switching rack.

Power

- 1x 63A single phase DSL ground level
- 1x 32A single phase DSL on fly floor
- 4x 32A single phase at rear of auditorium (2x house left of house left aisle, 1x house right of house left aisle, 1x house left of house right aisle)
- 4x double 13A on upstage wall
- 1x double 13A USL
- 3x double 13A DSR
- 3x double 13A DSL
- 1x True1 output in each stage floorbox (True1 to 13A extension leads available)
- Multiple 13A in control room
- Various 13A in foyer spaces
- Various 13A in auditorium roof space
- 13A outlets (fused at 3A) plus USB-A and USB-C at every other seating position in auditorium
- 1x 315A three phase supply on fly floor feeding local high power supplies including:
 - * 8x Strand LD90 24 channel with:
 - 24x 2.5kW modules (8 modules per phase)
 - * 1x Strand LD90 16 channel with:
 - 8x 5kW modules (split between phase 2 & 3)
 - 8x 2.5kW modules (phase 1)
 - * 1x Powerlock connection (protected by 250A circuit breaker)

Any temporary power distribution system exceeding 6kVA should be designed to BS7909 and accompanied with the relevant completion certificates (G1, G2 and G3)

An exterior cable pass is available behind the exit door DSR (downstage of pros arch) for connection to OB truck, or external generator. Access to ceiling void is also via this staircase, allowing cables to be easily routed to the control room, or stage as required.

Dressing Rooms

There are 6 dressing rooms as well as a costume and makeup room. Dressing room 1, 2 and 3 are on the ground floor. Dressing room 4, male & female toilets (including showers) and costume & makeup room is on the first floor. Dressing rooms 5 and 6 are on the second floor. All dressing rooms have sinks.

- Dressing room 1 can accommodate approximately 2-3 principals or can act as production office.
- Dressing room 2 can accommodate approximately 2-3 people. It also has a toilet.
- Dressing room 3 can accommodate approximately 5-8 people.
- Dressing room 4 can accommodate approximately 15-20 people.
- The costume and makeup room can accommodate approximately 5-7 people.
- Dressing room 5 can accommodate approximately 10-15 people.
- Dressing room 6 can accommodate approximately 20-30 people.

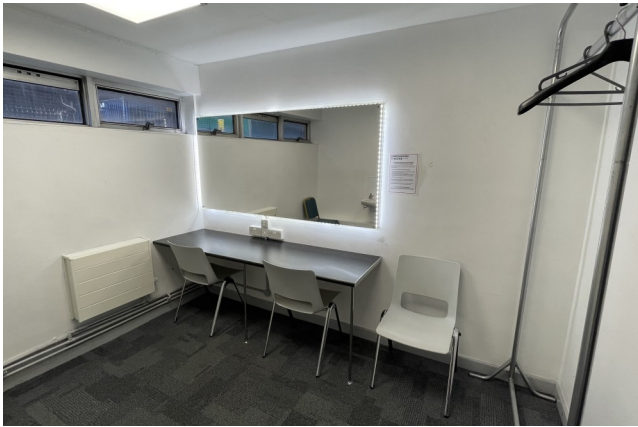

Lighting

Please note that we do request a basic standard rig after shows, so always allow time for this if you plan to deviate from our rig. The basic rig is as follows (plan on page 19):

- 4x Robe DL4S on FOH 2
- 4x Chauvet Ovation F-915FC on LX1
- 4x Chauvet Ovation F-915FC on LX4
- 8x Chauvet Ovation CYC 1 on LX6
- 8x Showtec Compact Par 18 on FOH 1
- 6x ½ kW Strand Quartet Fresnels on FOH 1
- 2x Chauvet Maverick Force S Profiles on Advance 1
- 2x Robe DL4S on LX2
- 8x Showtec Compact Par 18 on SR and SL perches
- 1x Martin Atomic Strobe on LX3
- 4x PAR 64 cans on each perch
- 1x ½ kW fresnels on each perch

Permanent power and DMX has been installed to these locations where required and we request that this isn't removed or altered without prior permission. You are welcome to add to this rig and we don't require you to remove additional equipment after your show. Our cable stock isn't listed here, but it is normally enough for most shows. If you have specific cable requirements, we would recommend bringing your own or hiring it in.

For control we use an ETC ION with a 20 fader wing and 208 channels of dimming provided by 9x Strand LD90 Dimmers located on the fly floor. Our lighting desk supports up to 8 universes.

Maximum load per phase per dimmer is 100A, total load must not exceed 315A per phase. Channels 1-200 are protected by a 13A MCB at the dimmer and feed out to facility panels around the theatre. Each channel has two 15A outlets. Channels 201-208 are protected by 25A MCB at the dimmer and feed out to facility panel around the theatre, each channel has 1x 32A connector and 4x 15A outlets locally protected by 4x 15A MCBs at the facility panel. *SEE ALSO: Page 11 - Power*

Various DMX points are located around the stage and in the roof space for all universes.

Pre-rigs are possible, but are *VERY* availability dependant. All rigs are subject to minimum four hour call with two technicians. Please check with King's Venues for prices and availability. Note that pre-rigs are normally more expensive than your own rigging sessions. Plans should be submitted in advance using in-house stock only.

Pyrotechnics will only be permitted with permission of theatre manager. A full and detailed risk assessment must be passed to the theatre manager at least 2 weeks prior to use. It will not be acceptable to use a stock or model risk assessment.

Lighting (continued)

Equipment	Quantity	Equipment	Quantity	
Profiles		PCs		
ETC Source Four Zoom	2	Strand Cantata PC	4	
ETC Source Four jr Zoom 25-50	2	Strand Quartet PC	3	
Strand Cantata 18/32	6	Parcans		
Strand Harmony 15/32	3			
Strand Harmony 12	3			
Strand SL 50	2			
Strand SL 30	2			
Strand SL 16/32	2	Par 64 (long nose)	12	
Strand Optique 15/42	3	Par 64 (short nose)	2	
Strand Optique 15/25	3	Par 16 (25w 240v)	12	
Fresnels		Floods		
		Strand Coda 500/1 (6 as HL)		9
		Followspots		
		Techlumen Arena MSR 1200w		1
		DMX Controlled Lighting		
CCT Starlette 1000*	2	Martin Atomic 3000	1	
CCT Minuette	5	Pulse MKII Par 56 LED	8	
DTS Scena 650/1000s	4	Showtec Compact Par 18 MKII	16	
Strand Cantata F	24	Robe DL4S Profile	6	
Strand Prelude F	2	Chauvet Ovation F-915FC	8	
Strand Quartet F	3	Chauvet Ovation CYC 1	8	
Strand Harmony F	1	Chauvet Maverick Force S Profile	4	
		Showtec Sunstrip Active MKII	4	
		Stairville BEL6 LED Uplighters	12	

*Not recommended for use or in various states of repair. Limited spares carried.

Sound

Please note that most of this equipment is installed and cannot be moved or changed, please contact us if you have any questions. Our cable stock isn't listed here, but is normally enough for most shows.

Details of how the equipment is connected is available on request.

We have a reserved channel from OFCOM for all radio microphones in the space. For information about frequency management, please get in touch.

Equipment	Quantity	Equipment	Quantity
PA		Other Audio	
DigiCo S31 Digital Mixing Console	1	DigiCo A168D 16x8 Stage Box	1
d&b Ali90 Left, Centre and Right Arrays	6	Studiospares 15m 8x4 XLR Multiway	1
d&b Vi-SUB	2	DI Box	10
d&b E6 Front Fill	4	XLR Tie Lines from Stage (sends)	13
d&b E6 Stage Monitors	2	XLR Tie Lines to Stage (returns)	5
d&b M4 Wedge Monitors	2	Microphone Stand (tripod)	4
RCF TT25-SMA Wedge Monitors	2	Microphone Stand (round base)	4
Genelec 8010A Control Room Monitors	3	Music Stands	15
		Various Lengths XLR	
Playback			
Apple Mac Mini with QLab 4 Pro Bundle	2		
Microphones			
Sennheiser EW100 G4 Beltpacks (CH39)	8		
Sennheiser EW100 G4 Handheld (CH39)	4		
Shure SM58	4		
Shure SM57	4		
Audio Technica PRO45 (flown)	3		
Rode NTG1	4		

Projection and AV

- Panasonic PT-RZ31K projector (with ET-D75LE30 (2.7-5.2:1) lens) (fixed in control room, fed via SDI from control room)
- Panasonic PT-RZ970 (with ET-DLE085 (0.8-1.0:1) lens) (mounted centre stage on Advance 1, fed via SDI from control room)
- Panasonic PT-RZ370 fixed in upper foyer (fed via SDI from control room)
- 2x Samsung 55" over-auditorium confidence monitors, fed via SDI from control room
- Lectern with Dell PC, Wolfvision Visualiser, HDMI, USB-C, Cynap Pure Pro, Logitech Spotlight, Mitel IP Phone, (connected to KCL telephone network), and Crestron control panel are also available.

Livestreaming

We have a built-in live streaming setup with operation from the control room, consisting of:

- 4x Panasonic AW-UE50 PTZ cameras
- Skaarhoj PTZ Extreme controller and video mixer
- Inputs for additional cameras
- Input for client laptop or in-house PC
- Audio feed from main theatre sound desk
- Output to streaming PC running OBS, Teams etc, plus local preview and program monitors

There is an additional charge to use the livestream facilities. Please contact King's Venues for our current rate.

Plans

Whilst PDF and DWG CAD plans are available on request, these drawings were made in 2000 and the venue has had internal alterations since then.

We strongly recommend a site visit to ensure the venue is suitable for your show.

All available plans follow.

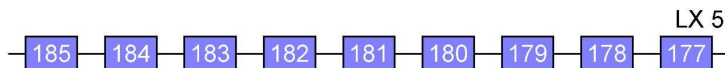
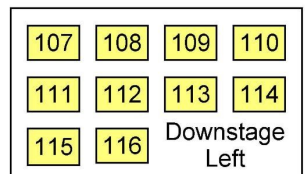
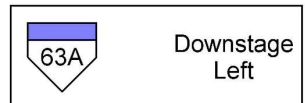
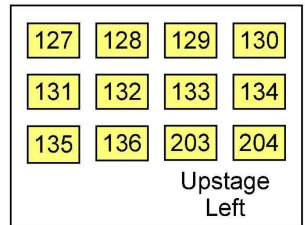
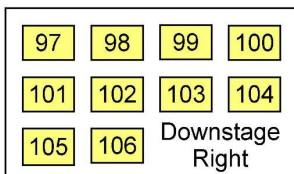
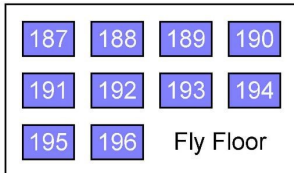
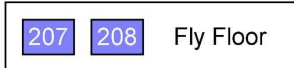
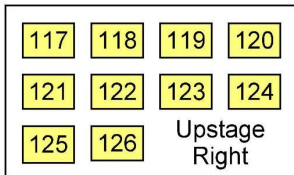

LX 5

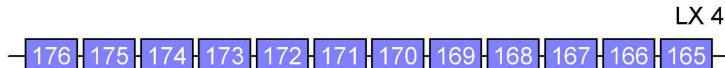

LX 4

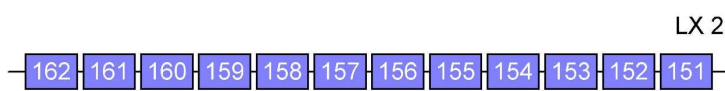

LX 2

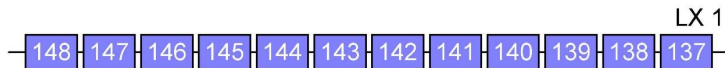

LX 1

SAFETY CURTAIN - KEEP CLEAR (cables at floor level only)

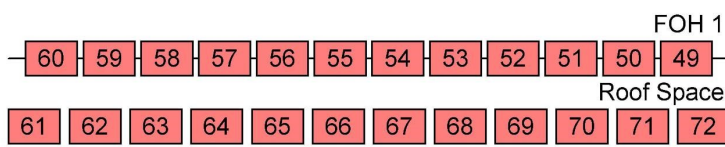
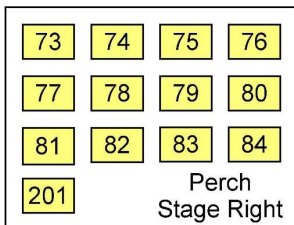

FOH 1

Roof Space

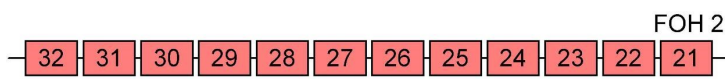
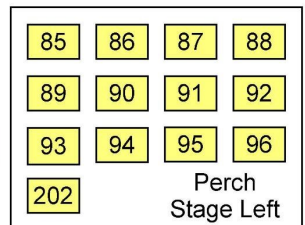

FOH 2

Roof Space

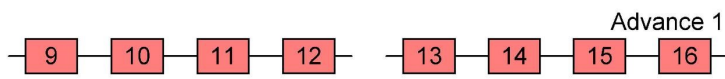
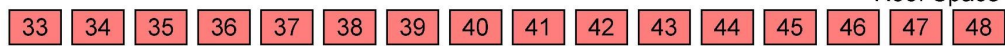

Advance 1

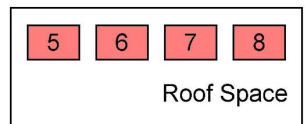
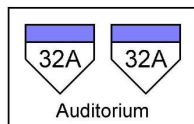
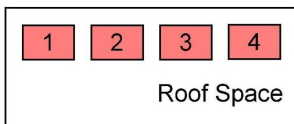
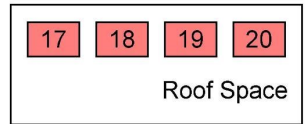

Colours show phasaes

2.5kW max load on 001 - 200. Each with 15A outlets (13A MCB on dimmer)

5.0kW max load on 200 - 208.

Each with 4x 15A (4x local 15A MCB) & 1x 32A outlet (25A MCB on dimmer)

150kg SWL UDL on Advance bar 1 and 2

250kg SWL UDL on FOH 1 and 2

300kg SWL UDL on each counterweight bar

SOCKET PLAN

**GREENWOOD
THEATRE**

Seating Plan

[illegible]

GWT Standard Rig

LX
Plot

SCALE: NOT TO SCALE

NOTES:

Colours are not exact

All locations are approximate

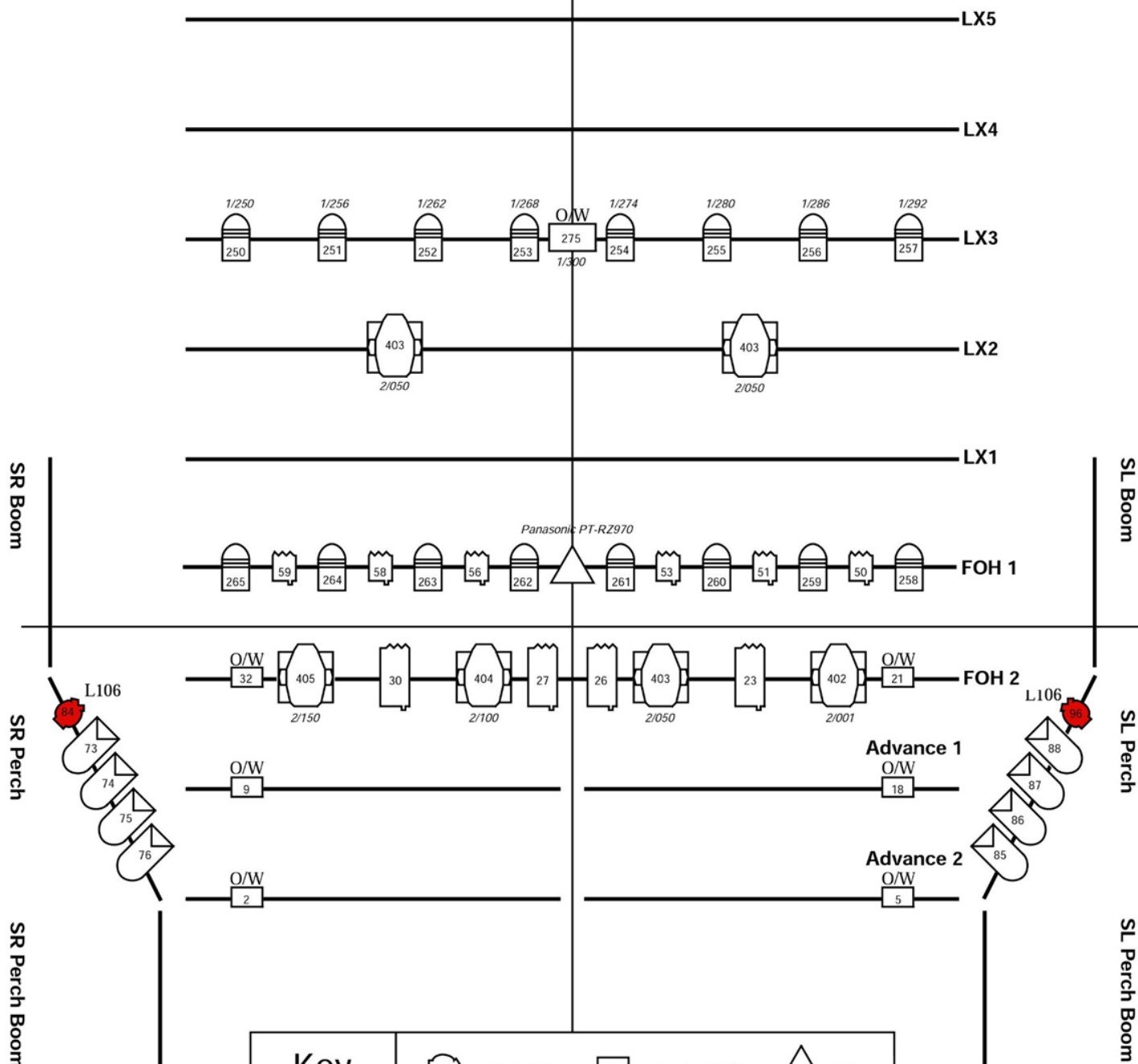

Key

Colour



DMX Address



Patt 123



Coda 500/1



Other



Atomic



Par 64



Quartet F



LED Par



Scena 1000



Robe DL4S

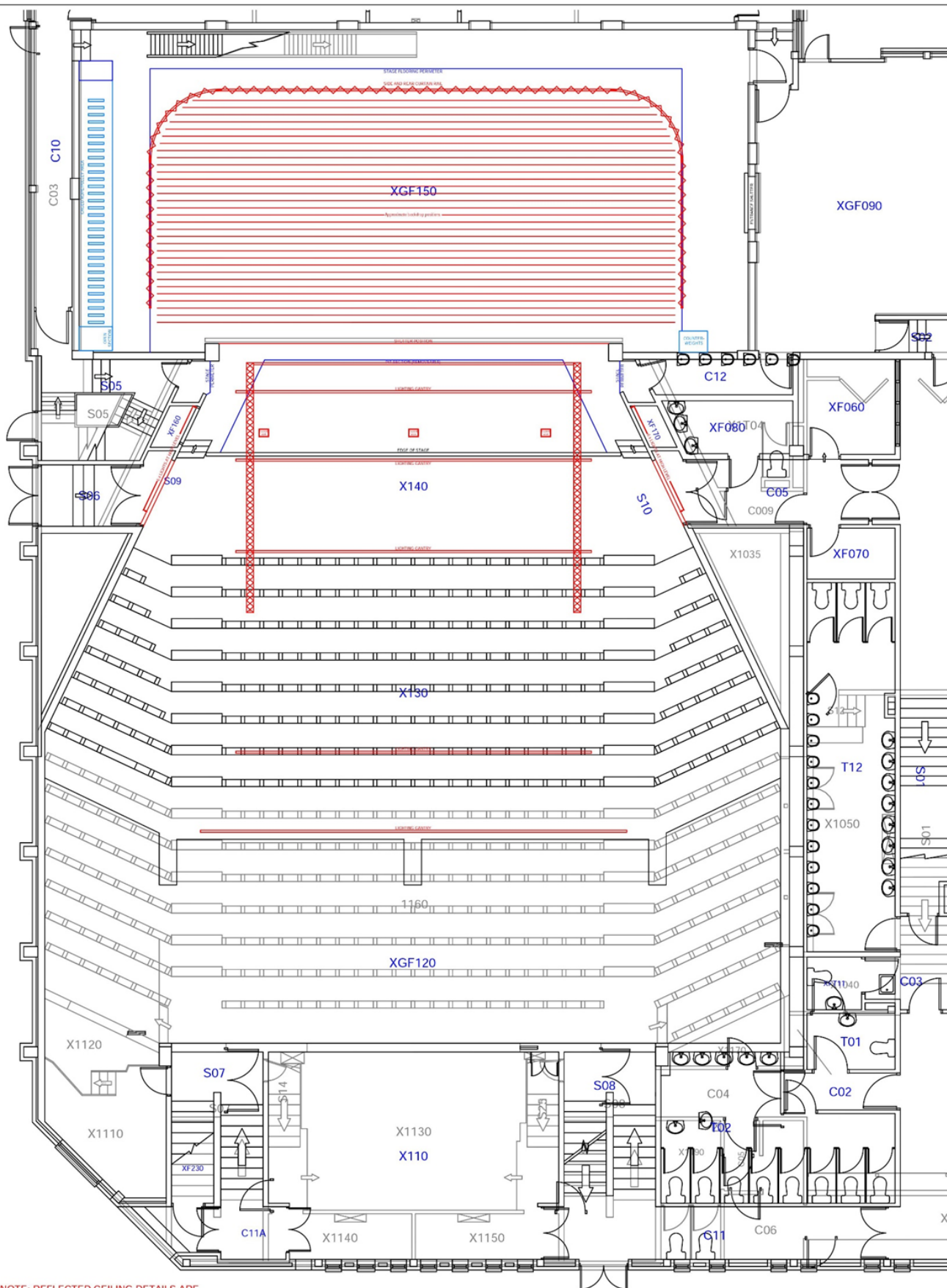

NOTE: REFLECTED CEILING DETAILS ARE APPROXIMATELY DRAWN FROM VISUAL OBSERVATION. DO NOT SCALE FROM THIS PLAN UNLESS PRINT COPY HAS BEEN CHECKED USING SCALE BAR

Scale 1 0 1 2 3 4 5 6 7 8 9 10 Metres

Location plan



GREENWOOD THEATRE
FLOOR PLAN WITH REFLECTED
CEILING DETAIL

KING'S
College
LONDON

King's College London

GREENWOOD THEATRE

GREENWOOD THEATRE G & 1ST DETAIL SURVEY 200514 R001.DWG











