

# Weston Education Centre Library

## Ground Floor

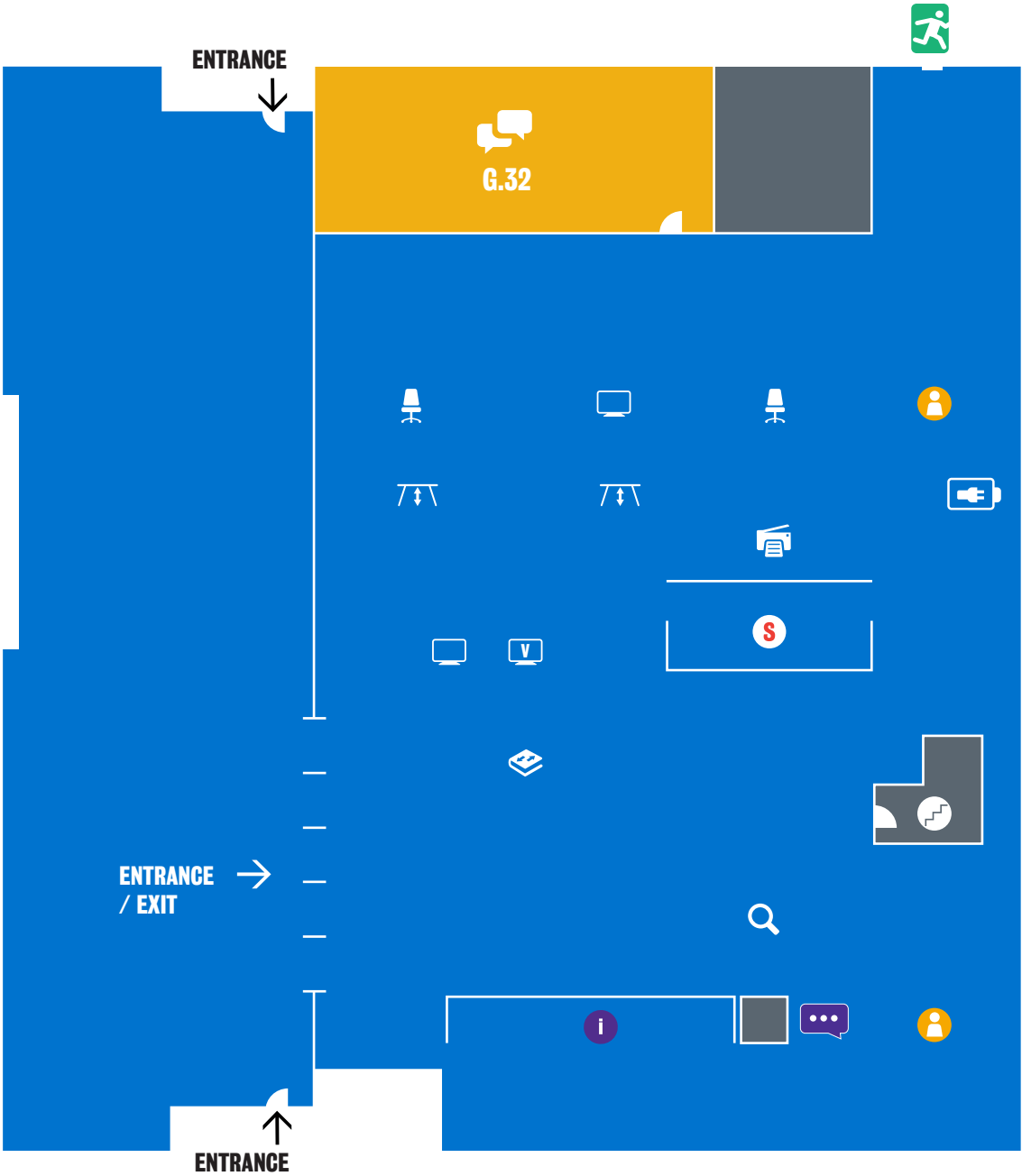

### Accessibility

- Fire Exit
- Stairs

### Facilities

- Chargebox
- Visitors' Computers

### Services

- Computer
- Group Study (GS)
- Height Adjustable Table
- Information Point
- LibChat PC
- Library Catalogue

- Print Copy Scan
- Self-Service
- Student Services
- Study Pod (SP)
- Study Area

### Zones

- Discuss Zone
- Quiet Zone

# Weston Education Centre Library

## First Floor

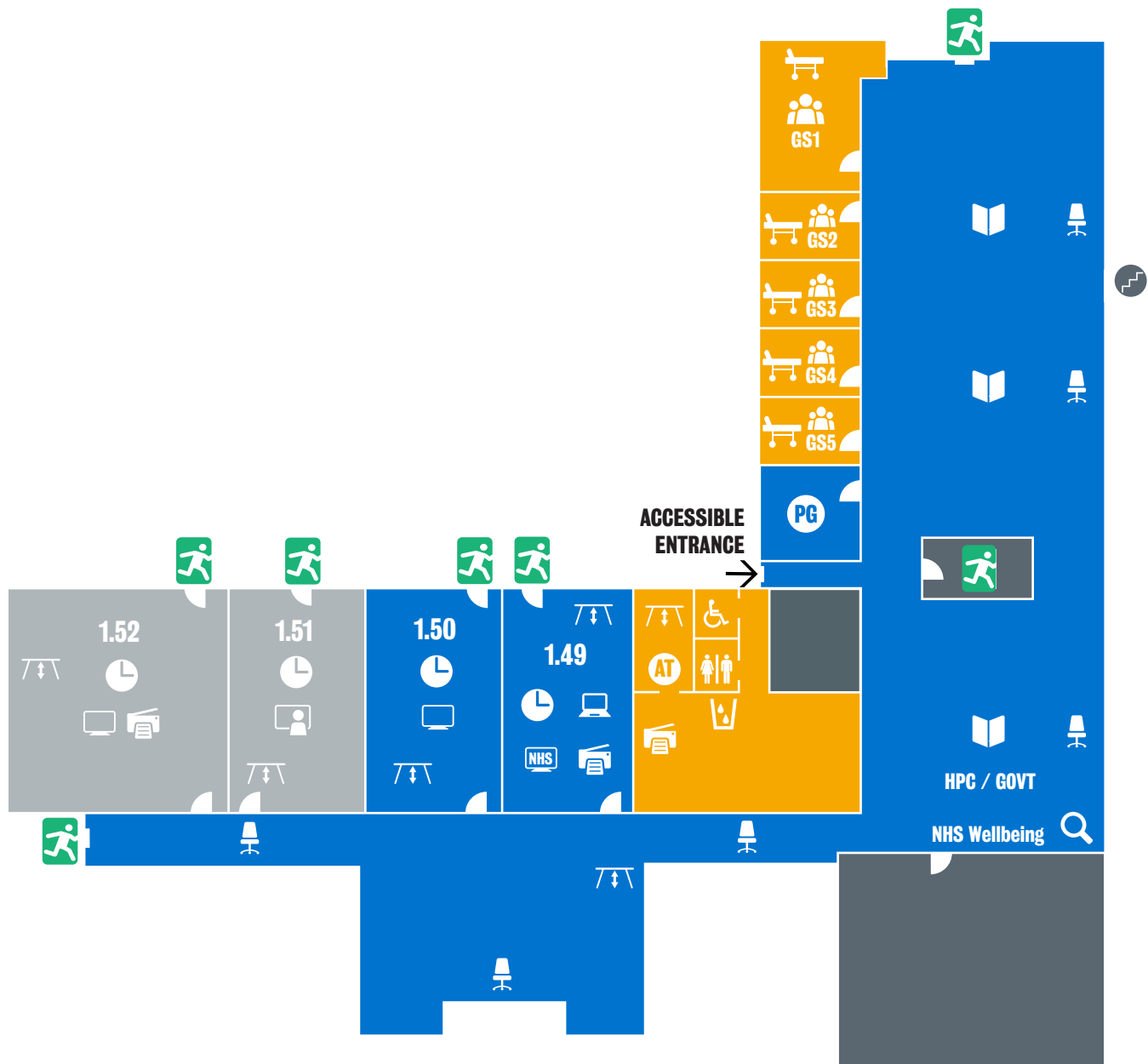

Accessibility

- Fire Exit
- Stairs

Facilities

- Accessible Toilet
- Books
- NHS Computer
- Toilets
- Water Fountain

Services

- 24-Hour Access
- Assistive Technology (AT)
- Computer
- Examination Couch
- Group Study (GS)
- Height Adjustable Table

- Laptop Loan
- Library Catalogue
- Print Copy Scan
- Study Area
- Training Room

Zones

- Postgraduate Zone
- Discuss Zone
- Quiet Zone
- Silent Zone

# Using Library Search to find a book

1. Type in the keywords (title or author) and click on the search icon 🔍

2. Click on the 'Available at...'

3. Click on 'GET IT' or scroll down to the Locations section

4. If 'Available' within the library note the library location e.g. Weston Education Centre and the classmark (classmark = shelf location code e.g. RC46 MED)

5. All Weston Education Centre Library books are located on the First Floor. Click "Locate" to view the library floor plan and find the book icons. Then, check the shelves for the book's classmark.

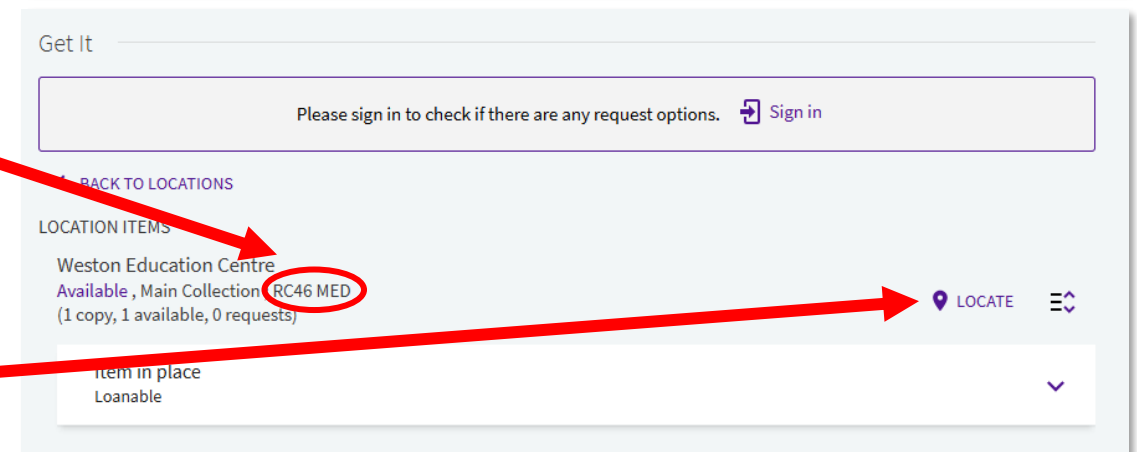
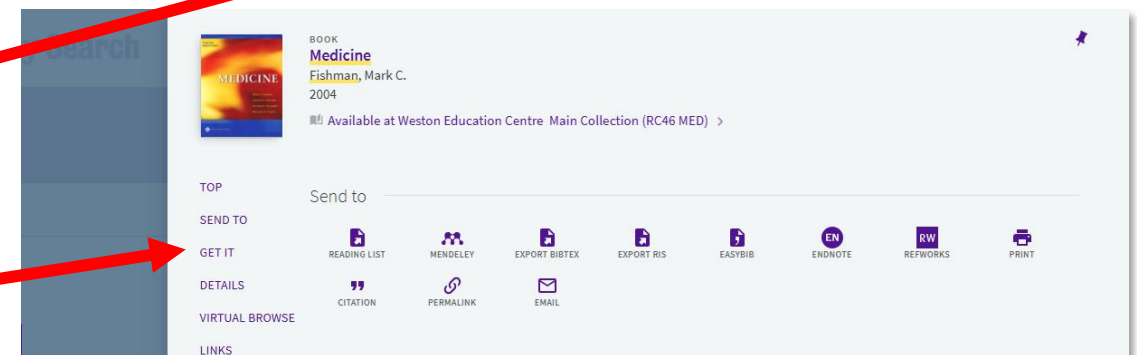
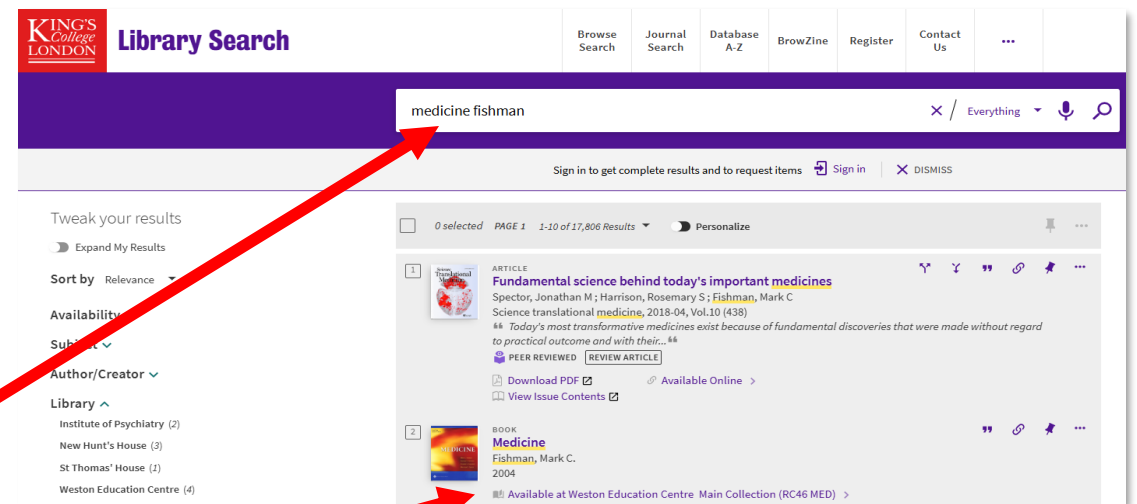

Are you new to Kings or want to find out about more advanced features for Library Search?

See the 'Getting Started with the Library' section in your subject Library Guide [libguides.kcl.ac.uk/home](https://libguides.kcl.ac.uk/home)

